

SHIMANO®

1987 REPAIR MANUAL

Shimano American Corporation, One Shimano Dr.
Irvine, CA 92718

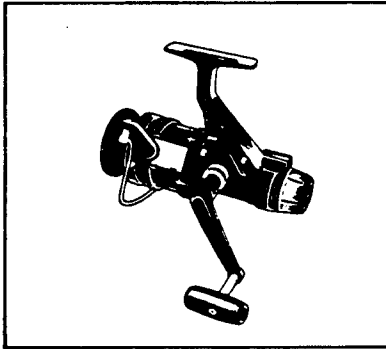

TO ORDER:

This reel belongs to the "Rear Drag" series.
Please order parts using the abbreviation
"RD" and the part number.

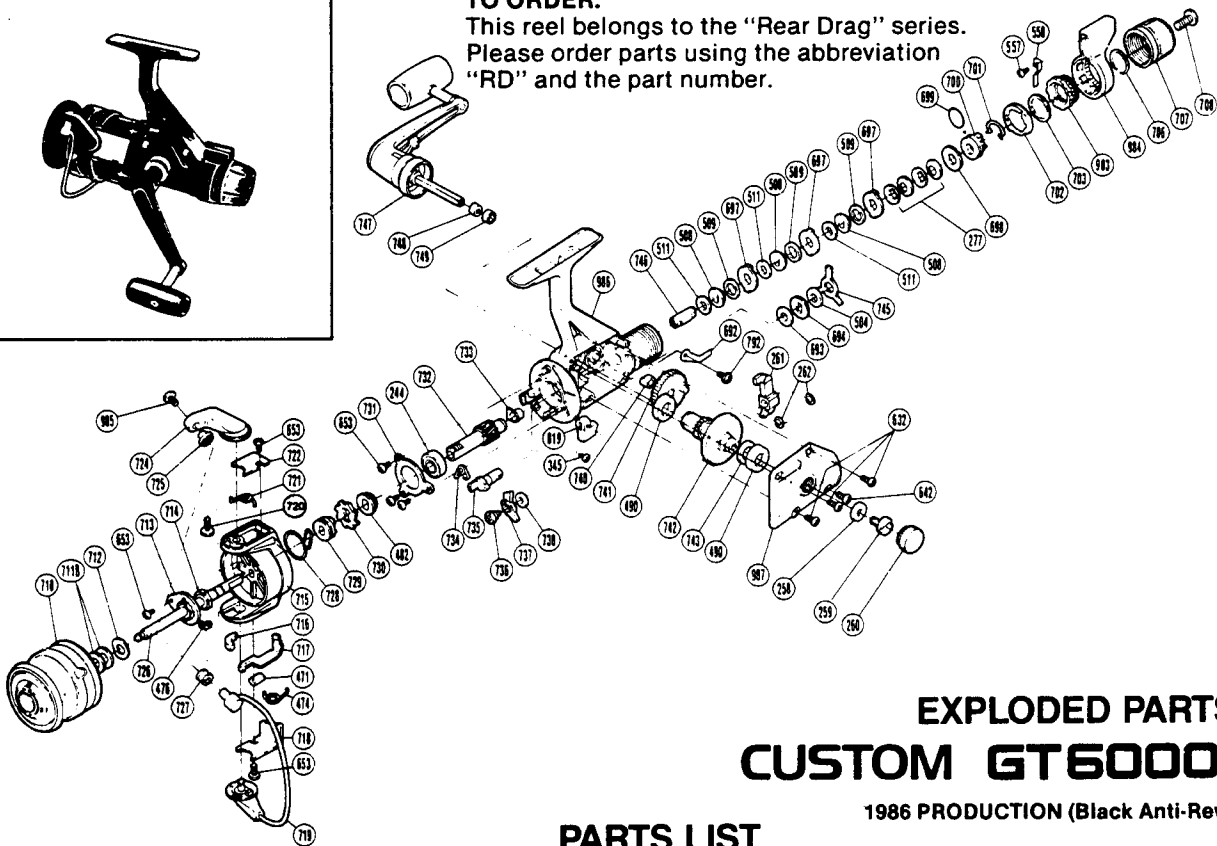

EXPLODED PARTS VIEW CUSTOM GT6000 *Plus*

1986 PRODUCTION (Black Anti-Reverse Lev)

PARTS LIST

PART # DESCRIPTION

244. Ball Bearing
258. Handle Lock Washer
259. Handle Lock Screw
(Originally 988)
260. Handle Screw Cap
261. Oscillating Slider
262. "C" Lock
277. Coned Disc Springs
345. Anti-Reverse Lever Screw
471. Trip Lever Guide
474. Lever Spring
476. "E" Lock
482. Pinion Spacer
490. Bushing
504. Drag Washer "C,"
508. Key Washer "A"
509. Drag Washer "F,"
511. Drag Washer "D,"
557. Fightin' Drag Click Screw
558. Fightin' Drag Click
632. Side Cover Screw A
642. Side Cover Screw B
653. Multi Purpose Screw
692. Drag Click
693. Drag Washer "C,"
694. Click Gear
697. Eared Washer "B"
698. Drag Spring Washer "A"

PART # DESCRIPTION

699. "O" Ring
700. Pressure Screw
701. Hold Click Spring
702. Lever Click Gear
703. Fightin' Pressure Screw
Washer
706. Lever Hold Spring
707. Drag Programmer
708. Drag Programmer Screw
710. Spool Assembly
711B. Spool Washer B
712. Tension Spring
713. Rotor Nut Lock Plate
714. Rotor Nut
715. Rotor
716. Bail Trip Slide Cam
717. Bail Trip Lever
718. Bail Trip Cover
719. Bail Assembly
720. Bail Arm Screw
(Originally 996)
721. Bail Spring
722. Bail Spring Cover
724. Bail Arm
725. Line Roller Washer
726. Main Shaft
727. Line Roller

PART # DESCRIPTION

728. Anti-Reverse Pawl Spring
729. Anti-Reverse
Spring Holder
730. Anti-Reverse Ratchet
731. Bearing Retainer
732. Pinion Gear
733. Pinion Gear Bushing
734. Anti-Reverse Cam Spring
735. Anti-Reverse Cam
736. Anti-Reverse Pawl Screw
737. Anti-Reverse Pawl
738. Anti-Reverse Pawl Spacer
740. Oscillating Gear Bushing
741. Oscillating Gear
742. Drive Gear
743. Drive Gear Washer
745. Eared Washer "B_F"
746. Drag Shaft
747. Handle Assembly
748. Handle Lock Spacer
749. Handle Lock Ring
792. Drag Click Screw
819. Anti-Reverse Lever
983. Fightin' Pressure Screw
984. Fightin' Drag Lever
985. Line Roller Screw
986. Body
987. Side Cover

Prices and specifications subject to change without notice.

JUNE 1987